

## T.T PUMPS

# Puddlepal™

## Submersible Dewatering Pump



### Features

- High abrasive resistance resin Vortex impeller
- Double mechanical seal
- Auto reset thermal protector
- Auto version for small pit usage
- Oil free motor
- Ability to pump down to 1mm
- Compact light design

### Application

- Hire fleets
- Cellars & basements
- Civil construction
- Quarries & mining
- De-watering

### Dimensions

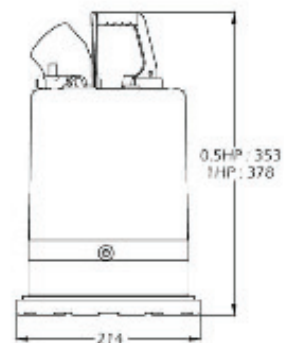
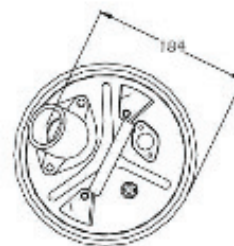

### Specifications

Model	Output		Discharge		Rated		Maximum		Cable M	Weight kg
	AMP	kW	mm	Inch	Head M	Capacity LPM	Head M	Capacity LPM		
PAL400 110V	6	0.4	50	2"	8	120	11	225	10	12
PAL400 230V	3	0.4	50	2"	8	120	11	225	10	12
PAL760 110V	11	0.75	50	2"	10	190	15.8	210	10	15
PAL760 230V	9.4	0.75	50	2"	10	190	15.8	210	10	15

### Parts & Material List

No	Part	Material
1	Handle	SS400
2	Motor Head Cover	ADC12
3	Out Cover	SUS304
4	Capacitor	
5	Stator	
6	Motor Housing	ADC12
7	Shaft & Rotor	SUS410
8	Seal Casing	ADC12
9	Pump Base	NBR
10	Pump Housing	FC20
11	Impeller	TPU 1/2HP Hyrel 1HP
12	Pecking	NBR
13	Mechanical Seal	SIC/SIC
14	Lower Bearing	
15	Upper Bearing	
16	Motor Bracket	SS400

Available in automatic versions, utilising the Waterguard and Watervole.

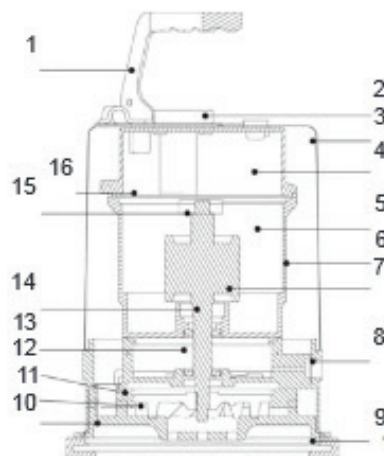

### Performance Curve

